

The Multiple Talent ...



PistenBully 100.

PistenBully. The series at a glance.

It's flattering to be so good
that people line up imitating you ...



1



2



3 4



Tried and trusted, a thousand times over. Right across the world.

PistenBully – a brand name that stands for quality. Whether it's in the endless wastes of Canada, the lonely forests of Scandinavia, the icy landscape of Greenland, or the famous ski slopes of the Alps – PistenBully is at home wherever performance counts.

One name, five model lines.

PistenBully covers every aspect of winter sports. From cross-country trails maintenance and steep-slope preparation to FunPark construction, PistenBully meets every challenge. Always at the cutting edge of technology and always on track with the latest trends and developments. Accessories and special designs meet individual requirements. PistenBully leads the way in innovation and is the world's number one in cross-country trail and slope maintenance.

The PistenBully 100. A unit that handles a whole range of tools.

Thanks to its modular concept, the PistenBully 100 is ideally suited to a whole range of special tasks. Its extraordinary flexibility makes the

PistenBully 100 totally effective both in summer and winter. It can be easily adapted to meet every demand, with a universal interface for attachments.



The multifunctional vehicle.

The PistenBully 100 is one unit with many possibilities. It specializes in cross-country ski trail and winter path maintenance and the preparation of small slopes, but it is equally at home in dealing with ski lifts -, and sledge - or snowmobile trails. Thanks to the modular system with different vehicle widths and accessories for a wide range of tasks, it appears tailor-made for the most diverse operations. The choice is yours: 2.5 m, 2.8 m, or 3.1 m, whatever you

need for your particular job. The track-setting pan creates top quality cross-country trails, and the low-emission engine means it can be used indoors as well as out. Add the balanced vehicle concept, the performance capacity, and the guaranteed economy of operation, and the PistenBully 100 really does pay off.

- 1** For the PistenBully 200, sustained use and large area coverage are no problem. In its favour in particular are the low operating costs, low fuel consumption, and long maintenance intervals.
- 2** The PistenBully 600 *Polar* with winch. A package filled with power and guaranteed economy in large-area operation.
- 3** The PistenBully 600 also provides excellent all-round visibility.
- 4** The PistenBully 600 *Park*: the special kinematics make the PistenBully 600 extremely manoeuvrable.
- 5** The PistenBully 100 brings cross-country trails up to world class standards.

5

The PistenBully 100. The Cockpit.

... one step ahead when it comes to ergonomics too.



Ergonomics and safety.

Where are the limits? Wherever operating the PistenBully can be made even more pleasant and safer, whether in Canada, Germany, or the Antarctic, the PistenBully 100 provides excellent freedom of movement both for driver and co-driver, as well as quiet and comfort, and good visibility by day and by night. And, of course, it's also easy to operate. These are the reasons why there are so many PistenBully units on the move.

Excellent visibility.

Excellent visibility is the be-all and end-all when it comes to driving a PistenBully. The PistenBully 100 has the striking PistenBully design, with generously-dimensioned front, rear, and side windows, and a large interior mirror. The front, rear, and side windows are heatable, as, of course, are the exterior mirrors. In rain and snow the two-speed parallel wipers and the double wiper system in the rear make for clear visibility however bad things may get. In the PistenBully 100 the driver always has a clear view – straight ahead and all around.

Comfort and functionality.

No contradiction with the PistenBully 100. A comfortable pivoting seat gives the driver plenty of adjustment possibilities. The convenient semi-

circular steering wheel provides excellent steering comfort. Switches and control instruments are arranged in function groups easy to reach and directly in the driver's field of view.



- 1 Functional in all details. Switches and control instruments are arranged by function group.
- 2 Multifunctional display for calling up different information at a glance.
- 3 Right where you need it: the fire extinguisher.
- 4 The handheld spotlight provides excellent illumination for tree-felling work, for example.
- 5 Getting every back into it – the pivoting seat can be adjusted in a multitude of ways at the push of a button.
- 6 The pivoting seat and armrests provide optimum comfort and a wide adjustment range.
- 7 Plenty of space and everything in view. The PistenBully 100 cockpit. Ergonomics pure and simple.

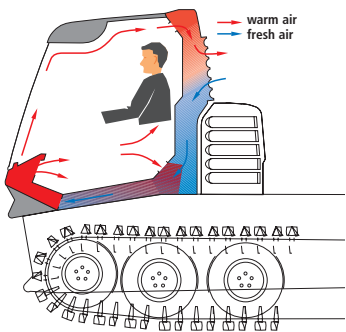

Keeps cool ...

The working climate in the cab of the PistenBully 100 is always pleasant, thanks to the combined heating and fresh-air ventilation system, with a powerful three-speed blower. Heat output and airflow are easy to vary and distribute inside the cab.

See and be seen.

Two H4 halogen headlamps take care of the forward lighting, with full and dipped beam. Two xenon headlights light up the area in front of the unit and the middle distance. Two powerful reversing spotlights provide generous lighting to the rear, and two all-round lamps with integrated flashers and rear lights make you easy to see too.

The PistenBully 100 *AllSeason* / PistenBully 100 *Indoor*.

In nature, survival of the fittest means adapting faster to changing conditions.



One unit, universal use.

The PistenBully 100 *AllSeason* really is a machine for 360 days a year. When it comes to operating potential, a wide range of different track options provide unbeatable flexibility. Working in wet areas or deep in the woods, the PistenBully 100 *AllSeason* is king. Within the permissible attachment torque values, all types of attachments used for communal and agricultural purposes can be employed, with cat. 2 three-point hitch.

A loading platform that can be built on.

The loading platform of the PistenBully 100 *AllSeason* can accommodate all kinds of attachments, such as ditch cutters, plant-hole drills, fertilizer spreaders and spray containers. 129 hp is available with a hydraulic connection and, with power take-off shaft connection, 90 hp at 1,000 rpm provides plenty of power to drive plenty of options.

Slope maintenance – indoors.

The PistenBully 100 *Indoor* is almost tailor-made for slope maintenance in ski domes. Almost nothing to be heard and absolutely nothing to smell. It brings with it everything needed for indoor operation. Thanks to integrated exhaust-

gas purification and a soot filter, the PistenBully 100 *Indoor* is absolutely ready for the challenge of operation in the hall. Someone who works cleanly should leave things clean behind them too.



- 1** Thanks to its extremely low ground pressure, the PistenBully 100 *AllSeason* can be used in particular in situations in which wheeled vehicles have reached the limits of their capacity.
- 2** The PistenBully 100 *Indoor* really feels at home with a roof over its head.
- 3** An integrated emission control and soot filter guarantee clean operation.

Completely different circumstances.

Long, extended indoor halls call for a very high degree of manoeuvrability, and that's something the compact PistenBully 100 *Indoor* provides. Artificial snow is handled with maximum sensitivity. The PistenBully doesn't have much room for movement. It has to operate in tight spaces. It needs to take account of the light steel framework which serves as the hall substructure. Demands that this talented lightweight masters with ease.

Low emissions, high performance.

In hall situations in particular, the snow is conveyed to the sides of the slopes and gathers at the end of the slope. The PistenBully 100 *Indoor* therefore has to perform at its best overnight. Thanks to the environmentally-friendly diesel engine with exhaust-gas purification, the PistenBully 100 *Indoor* is the ideal solution even for operations in spas, clean-air vacation resorts where fresh air is vital, and in sensitive landscape situations too.

The PistenBully 100. The accessories.

More versatile than all the others put together.



1



3



2



4

5



A range of variation that opens up new possibilities.

The key feature of the PistenBully 100 is its enormous range of operational possibilities. It can be used as a taxi to carry passengers to slopes in difficult-to-access terrain. It can clear masses of snow from passes and mountain roads. With the right accessories, the possibilities for this multiple talent are almost endless.

A taxi that goes everywhere.

With space for four or for up to ten people in the passenger cab, the PistenBully 100 is an economical transport solution in really difficult-to-access locations. The cab is simply secured as an attachment on the platform, meaning your material can also be transported on the loading surface, regardless of the weather.

The ice-breaker.

Hard, icy snow? With the SnowCutter, the PistenBully 100 can cut lumps of ice into millions of fragments with ease. The rear-mounted snow tiller

integrates it back into the slope surface. The SnowCutter can handle all this in just one cycle. It's ideal for renewing lift runs.



- 1 The SnowCutter breaks up hard and iced-up slope sections.
- 2 Don't worry! The brush guard protects your windscreen and your headlights.
- 3 Icing up? Impossible. Heated windscreen wipers are extremely useful when the temperature gets really low.
- 4 Xenon working lights provide optimum lighting over the working area.
- 5 With a PistenBully 100 and front snow-blower, you can clear passes, mountain roads, car parks etc. with ease.
- 6 Together with the VarioTrackDesigner, the PistenBully 100 brings cross-country ski trails up to world class standards.

PistenBully 100 with VarioTrackDesigner.

The snow and temperature conditions may be at their worst, but the VarioTrackDesigner can still create perfect cross-country ski trails and provide the solution for your individual needs, ranging from high-performance or long-distance sports to special ski tracks for children's cross-country. The track tiller of the VarioTrackDesigner processes the area in front of the track-setting pan to a depth of up to 5 cm and loosens up even heavily iced trails. Your choice:

the track tiller and pans can be raised individually, the right-hand pan can be moved laterally and even the track width can be adjusted.

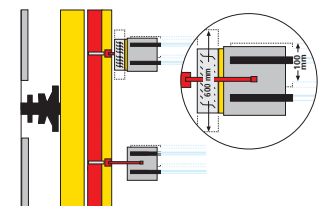
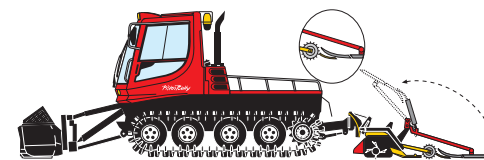

The PistenBully. Service and performance.

A partnership with the promise of success. You and us.



Always there for you.

With more than 130 service facilities and local representations worldwide. 24 hours a day, 7 days a week and 52 weeks a year, rapid support and spare parts supply are guaranteed. In addition, an efficient concept comprising training, consultancy, communication and exchange of experience ensures your independence.

Service know-how that we share.

We base ourselves on a service concept that brings our customers in close. As partners. We provide comprehensive training for drivers and fitters and pass our knowledge on along the way. You benefit from our long years of experience and our know-how. As well as that, we provide you with detailed documentation, containing all the details relating to the vehicle. Help for self-help.

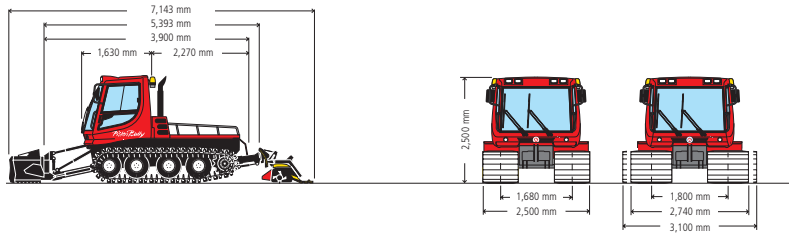

The PistenBully 100 / PistenBully 100 Indoor / PistenBully 100 AllSeason

Track widths		1,680 mm/66"		1,800 mm/71"		Engine			
Dimensions		Width				Type	Mercedes-Benz		
		over combined tracks		2,500 mm 98"	2,740 mm 108"	3,100 mm 122"	OM 904 LA		
		over steel tracks		2,500 mm 98"	2,740 mm 108"	-	Cylinders	4	
		over snow tiller and intermediate flaps*		3,570 mm 141"	3,870 mm 152"	4,170 mm 164"	Displacement	4,250 cc 260 cu. in.	
		Height with cab tilted		3,020 mm 119"			Power output (ECE)	129 kW (176 hp)	
		Overall height		2,500 mm 98"			Max. torque	675 Nm/1,200 rpm	
		Ground clearance		320 mm 13"			Fuel consumption from	8.5 l/h 2.2 gal	
		Loading surface (L x W)		1,620 x 1,920 mm 64" x 76"			Tank capacity	150 l 40 gal	
Weight						Brakes			
		Unladen weight with combined tracks		3,600 kg/7,900 lbs.	3,700 kg/8,100 lbs.	3,800 kg/8,400 lbs.	Using hydrostatic transmission, with no mechanical wear.		
		Unladen weight with steel tracks		3,700 kg/8,157 lbs.	3,800 kg/8,400 lbs.	-	Two multi-disc parking/holding brakes.		
		Permissible gross weight incl. additional equipment		5,200 kg/11,464 lbs.				Electrics	
		Payload on loading surface without additional equipment		1,000 kg/2,205 lbs.				Voltage system	24 Volt
Performance data								Alternator	28 V/100 A
		Speed, continuously variable		0 - 25 km/h 0 - 16 mp/h			Batteries		2 x 12 V/92 A
		Specific ground pressure with combined tracks		0.066 kg/cm ² 0.94 psi	0.059 kg/cm ² 0.84 psi	0.051 kg/cm ² 0.71 psi	Cold-start rating		395 A
		Specific ground pressure with steel tracks		0.068 kg/cm ² 0.97 psi	0.061 kg/cm ² 0.87 psi				
		Area coverage (with snow tiller)		37,500 m ² /h 44,850 yd ²	41,000 m ² /h 49,040 yd ²	44,500 m ² /h 53,222 yd ²			

Additional equipment	
Front	All-Way Blade, Front snow-blower, SnowCutter, Front-Renovator
Rear	Snow tiller with track-setting device, Rear Compactor, VarioTrackDesigner
Superstructures	Passenger cab for 4 or 8-10 persons

* Over snow tiller and flaps (intermediate flaps demounted) 3,100 mm 122" 3,400 mm 134" 3,700 mm 146"
 Over snow tiller and hydraulically foldable side flaps (optional) 4,440 mm 175" 4,740 mm 187" 5,040 mm 198"

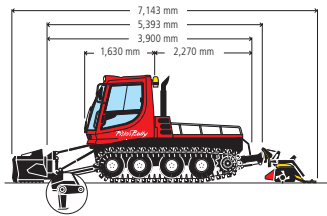

SnowCutter

Technical data

Working width	2,700 mm	106"
Weight	approx. 260 kg	573 lbs.

Use

The SnowCutter is used for ripping up icy, hard sections of the ski slope and for renewing lift runs. It is used with the U-blade and the All-Way Blade.

How it works

With the aid of the pivot cylinder, the toothed bar is moved downwards. This breaks up hard and iced-up slope sections into coarse fragments. Driving over these with the tracks breaks them up into smaller pieces: the smaller pieces are then incorporated into the slope by means of the snow tiller. If the toothed bar encounters rocky substrate it automatically pivots back up again. The hydraulic adjustment is carried out by the manual control unit and the quick-change system.

Design

The SnowCutter is an adapter piece between the quick-change system and the All-Way Blade, which can be fitted and removed with no problem at all. The tough toothed bar is made of wear-resistant steel. Its low weight means it need never be removed from the vehicle.

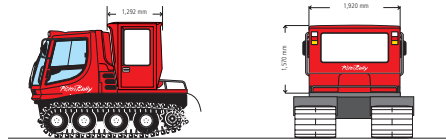

Passenger cab

To carry 4 people

Technical data

Height	approx. 1,600 mm	106"
Width	1,920 mm	76"
Length	1,300 mm	51"
Load platform area	550 x 1,830 mm	22" x 27"
Entry height	990 mm	39"
Overall height (vehicle and cab)	2,540 mm	100"
Weight	290 kg	639 lbs.
Payload (incl. loading platform)	710 kg	1,565 lbs.
Number of passengers	max. 4	
Supplementary tank capacity	9.5 l	2.5 gal

Use

This passenger cabin is suitable for carrying up to four people and for transporting sensitive material and objects.

Design

The cab consists of a steel frame and FRP components. The interior is provided with cladding made of hard-wearing sound-insulating nonwoven fleece material, and is equipped with a folding bench with four seats. The passengers sit facing in the direction of travel. For their safety waist seat belts are provided, and a bar for holding onto is also provided in the middle of the cab roof. The door is on the right side and is provided with entry aids. The cab is separately heated and a double sliding window allows for communication with driver's cab.

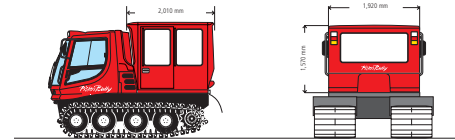

Passenger cab

To carry 8-10 people

Technical data

Height	approx. 1,600 mm	63"
Width	1,920 mm	76"
Length	2,010 mm	79"
Entry height	990 mm	39"
Overall height (vehicle and cab)	2,540 mm	100"
Weight	400 kg	882 lbs.
Payload	600 kg	1,323 lbs.
Number of passengers	max. 10	
Supplementary tank capacity	9.5 l	2.5 gal

Use

This passenger cabin is suitable for carrying up to ten people and for transporting sensitive material and objects.

Design

The cab consists of a steel frame and FRP components. The interior is provided with cladding made of hard-wearing sound-insulating nonwoven fleece material. The two bench units located opposite one another each have four seats. As an option, a third bench for two persons can be fitted. Waist seat belts are provided for passenger safety, and a bar is located in the middle of the cab roof for passengers to hold onto. With the seats folded up, the cab has plenty of room for transporting material. The door is on the right side. The cab is separately heated and a double sliding window allows for communication with driver's cab.



Snow-blower

Technical data

Auger diameter	550 mm	22"
Impeller diameter	520 mm	20"
Clearing width	2,700 mm	106"
Clearing height	720 mm	28"
Overall height	approx. 1,600 mm	63"
Ejecting distance (adjustable)	30 m	33 yd
Weight	approx. 640 kg	1,411 lbs.

Use

With this attachment in position the PistenBully can also be used for snow clearing work.

Design

The Snow-blower consists of a spiral cutter blade and two impeller with 2 chutes. The generous size and cross-section of these components makes the attachment highly efficient. The ejector chute can be turned hydraulically through 250 degrees. Its angle is also adjustable. The ejector flap on the chute is repositioned hydraulically, so that the ideal ejecting width can be chosen. The ejection width can thus be optimally adjusted. Two double-acting control circuits are used, with operation from the front-end attachment controls in the driver's cab. The attachment can be repositioned sideways so that it can operate across the entire width of the vehicle.

Kässbohrer Geländefahrzeug AG

Kässbohrerstraße 11, 88471 Laupheim/Germany
Phone: +49 (0) 73 92/9 00-0, Fax: +49 (0) 73 92/9 00-4 45
www.pistenbully.com, e-mail: info@pistenbully.com

Austria

Gewerbestraße 173, 5431 Kuchl
Phone: +43 (0) 62 44/4 00 10, Fax: +43 (0) 62 44/40 01 11
www.pistenbully.at, e-mail: office@pistenbully.at

Switzerland

Bruneggerstraße 45, 5103 Möriken
Phone: +41 (0) 62/8 87 70 50, Fax: +41 (0) 62/8 87 70 51
www.pistenbully.ch, e-mail: info@pistenbully.ch

Italy

Via Galileo Galilei, 32, 39100 Bolzano
Phone: +39 (0) 4 71/93 30 27, Fax: +39 (0) 4 71/93 29 75
www.pistenbully.it, e-mail: info@pistenbully.it

France

Kässbohrer E.S.E.
Portes de Tarentaise, 73790 Tours en Savoie
Phone: +33 (0) 4 79/10 46 10, Fax: +33 (0) 4 79/10 46 40
www.pistenbully.fr, e-mail: info@pistenbully.fr

USA

Kässbohrer All Terrain Vehicles Inc.
750 A South Rock Boulevard, Reno Nevada 89502
Phone: +1 (0) 7 75/78 57-50 00, Fax: +1 (0) 7 75/8 57 50 10
www.pistenbullyusa.com, e-mail: info@katvpb.com



KÄSSBOHRER GELÄNDEFahrZEUG AG

A note on the contents of this brochure: The products shown here are subject to technical and equipment changes after closing for print. Pictures in this brochure may also show accessories and optional equipment that are not included in the product's standard delivery specification. Due to the limitations of the printing process, illustrations may show products in slightly inaccurate colors. Statements on legal or tax-relevant regulations and their effects are valid for the Federal Republic of Germany only. For the latest status, please call your contact at Kässbohrer Geländefahrzeug AG. Printed in Germany on chlorine-free bleached paper . 075 · 4/2007 · e1 · GE 2.000

One call and real help is on the way.

You are welcome to put a call in to our Quality Center. We're there to listen. And to provide advice and support for the operation, maintenance and upkeep of your PistenBully 100, guaranteed. The Quality Center will

send you any spare parts you need by the quickest possible route.

Customers who have been with us for years know that they can put their trust in our service support. For perfect operation, constant availability of your vehicle and low operating costs.



A strategy that pays off.

We think about a lot. Including the costs to you. And that's why we practice a matching part policy with our customers. It's a strategy that pays dividends: whenever possible, maintenance parts and components subject to wear that can be used throughout the PistenBully family are fitted. This makes storing your spare parts easier, especially with a uniform PistenBully fleet.

Access that works.

To carry out servicing on the PistenBully 100, the cab and platform tilt hydraulically. The cab tilts forwards and the platform backwards, individually or together. This allows you to access to the main elements quickly and easily. A well thought-out, cost-effective overall vehicle concept, especially in terms of maintenance.

- 1** Ideally equipped for every task: There is a big choice of tracks for every PistenBully.
- 2** Knowledge is priceless. We provide your drivers and service staff with our know-how as we go along, for work in and on the vehicle.
- 3** No vehicle ever leaves the plant without a complete inspection. And everything is checked and tested a second time on the modern performance test stand before delivery.
- 4** We're there when you need us – immediately. The worldwide PistenBully service is on the spot, straight away.
- 5** Fast and easy access: the cab and the platform of the PistenBully 100 can be hydraulically tilted to carry out servicing.